

Perma-Column® Deck Posts



BUILD FAST. BUILD TO LAST.

The patented design of Perma-Column® combines precast concrete with rebar reinforcements and a welded powder-coated steel bracket for durability and speed. Certified code compliant by ICC Evaluation Services.



© 2019 Perma-Column, LLC. All rights reserved.



BUILD ON A PERMANENT FOUNDATION



Precast Deck Posts



Composite Post Footers

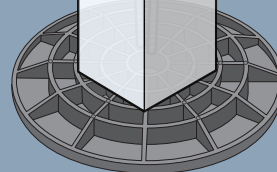

800-798-5562 www.midwestpermacolumn.com

19-PC-42_MPC

© 2019 Perma-Column, LLC. All rights reserved.

BUILD DECKS FASTER, SMARTER, AND EASIER!

ELIMINATE THE NEED FOR READY-MIX CONCRETE



Perma-Column® Precast Deck Posts



FootingPad® Composite Footers

FootingPad® Post Footers

START OFF ON THE RIGHT FOOT

The patented composite design of FootingPad® provides the durability and strength your deck needs at a fraction of the time, cost, and weight of concrete. Certified code compliant by ICC Evaluation Services.

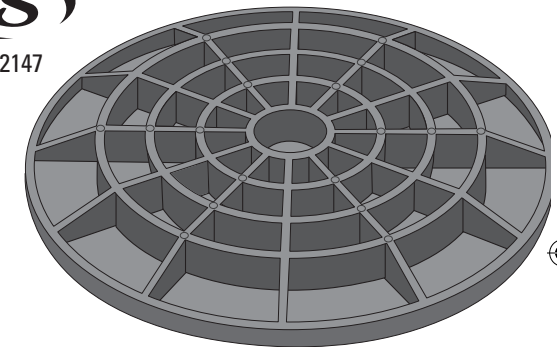

Save time. Save cost. Save weight.



THE PERFECT COMBINATION



Replaces concrete footings of equal diameter

- 10" and 12" sizes support 4x4 or larger posts
- 16" and 24" sizes support a 6x6 or larger posts
- Allowable loads determined by type of supporting soil

Easy to work with

- Eliminate the hassles of transporting heavy concrete
- FootingPad® weighs as little as one pound each
- No additional labor or equipment rental needed
- No waiting for concrete to cure, build same day

Environmentally friendly

- Made in US from recycled materials
- Backed by a lifetime warranty

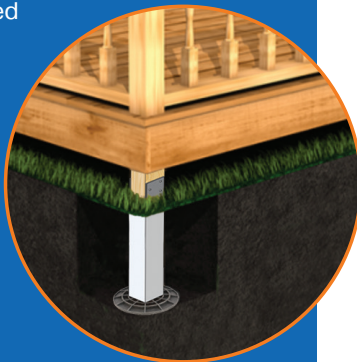

Avoid the hassles of mixing and pouring concrete in the field. Build decks faster and easier with ICC-approved building materials—Perma-Column® precast deck posts and FootingPad® composite post footers. The permanent deck foundation system that lasts for generations.

FOOTINGPAD® LOAD TABLE

Pad diameter	Thickness (in)	Weight (lb)	LOAD CAPACITY PER POST AT:		Best uses
			1500 psf soil capacity	3000 psf soil capacity	
10 inch	1	1	810	1622	Decks and small post-frame structures
12 inch	1-1/2	2.1	1126	2356	Decks and post-frame structures
16 inch	1-1/2	4	2009	4200	Larger decks and post-frame structures
24 inch	2-1/2	13	4013	9327	Larger decks and post-frame structures



PERMA-COLUMN® LOAD TABLE

Model ID	Width (in)	Depth (in)	Length (in)	LOAD AND RESISTANCE FACTOR DESIGN (LRFD)						ALLOWABLE STRENGTH DESIGN (ASD)					
				P _{LRFD} (lb)	M _{LRFD-X} (ft-lb)	M _{LRFD-Z} (ft-lb)	V _{LRFD-X} (lb)	V _{LRFD-Z} (lb)	T _{LRFD} (lb)	P _{ASD} (lb)	M _{ASD-X} (ft-lb)	M _{ASD-Z} (ft-lb)	V _{ASD-X} (lb)	V _{ASD-Z} (lb)	T _{ASD} (lb)
DP4430	3-5/8	3-1/2	30	46,076	1456	1400	952	986	956	28,798	910	875	595	616	636
DP4440	3-5/8	3-1/2	40	46,076	1456	1400	952	986	956	28,798	910	875	595	616	636
DP4448	3-5/8	3-1/2	48	46,076	1456	1400	952	986	956	28,798	910	875	595	616	636
DP4460	3-5/8	3-1/2	60	46,076	1456	1400	952	986	956	28,798	910	875	595	616	636
DP6630	5-5/8	5	30	101,268	2981	4048	2109	2900	1658	63,293	1863	2530	1318	1813	1103
DP6640	5-5/8	5	40	101,268	2981	4048	2109	2900	1658	63,293	1863	2530	1318	1813	1103
DP6648	5-5/8	5	48	101,268	2981	4048	2109	2900	1658	63,293	1863	2530	1318	1813	1103
DP6660	5-5/8	5	60	101,268	2981	4048	2109	2900	1658	63,293	1863	2530	1318	1813	1103
DP6430	6-1/8	5	30	109,556	3215	4048	2297	3388	1289	68,472	2009	2553	1436	2117	857
DP6440	6-1/8	5	40	109,556	3215	4048	2297	3388	1289	68,472	2009	2553	1436	2117	857
DP6448	6-1/8	5	48	109,556	3215	4048	2297	3388	1289	68,472	2009	2553	1436	2117	857
DP6460	6-1/8	5	60	109,556	3215	4048	2297	3388	1289	68,472	2009	2553	1436	2117	857

For SI: 1 inch = 25.4 mm, 1 pound = 4.4482

¹ For biaxial bending: $\frac{m_x}{M_x} + \frac{m_y}{M_y} \leq 1$

² The tabulated values account for combined axial compression load and bending moment load. No reduction in axial compression loads and bending moment loads for combined axial compression bending moment is required.

³ For combined tension loads and bending moment loads: $\frac{t}{T} + \frac{m}{M} \leq 1$



3x stronger than standard concrete

- 10,000 psi precast concrete pier
- Powder-coated steel bracket
- Rebar reinforced

Sized to meet your needs

- 4x4 and 6x6 sizes in 30", 40", 48", and 60" lengths
- Uplift anchors and 12" column extenders available

Environmentally friendly

- No harmful or toxic chemicals
- Backed by a lifetime warranty



Installs with ease:

1. Dig post hole to required depth below frost line.
2. Level and tamp dirt at bottom of hole.
3. Place FootingPad® with ribbed side UP.
4. Place Perma-Column® Deck Post onto pad.
5. Backfill dirt in 12" lifts, tamp after each lift.